



SUBASHYA

VIMAL HOMES



 SUBASHYA
VIMAL HOMES

PARKING FLOOR PLAN



VIMAL HOMES



TYPICAL FLOOR PLAN (FLOORS 1-3)

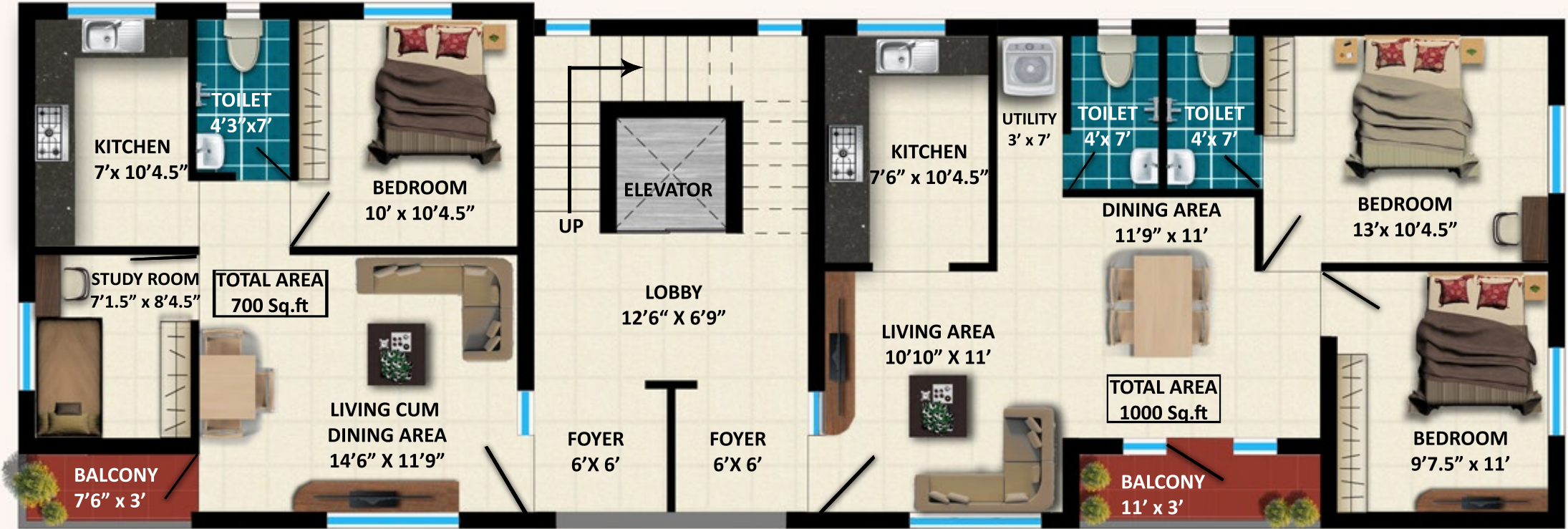

KEY MAP

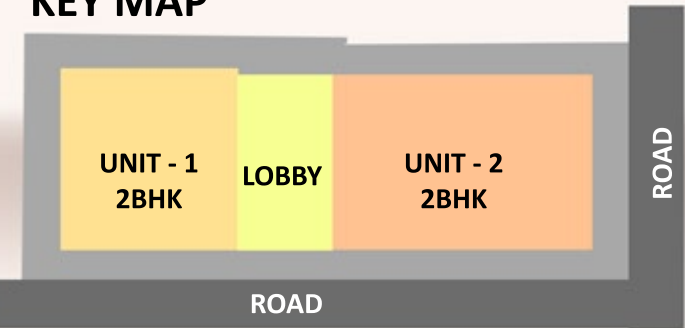

VIMAL HOMES



Specifications

Structure

R.C.C. framed structure with first class brick walls plastered.

Flooring:

a. Hall / Dining, Bedroom & Kitchen

Joint free 2x2' Vitrified Tiles

b. Toilets

Around Dadoing Joint free Vitrified Tiles up to Roof height & Antiskid Vitrified Tiles Flooring.

Doors

a. Main Door

Teak Wood Polished Frame & Door and Wooden Framed Grilled Gate with Brass Fittings.

b. Bedroom & Toilets

Teak Wood Polished Frame with Indonesian Teak wood door & S.S.Fittings.

c. Other Doors

Teak wood Enamel Painted Frame with Water Proof Flush Doors & Powder coated Fittings.

Windows

Teak Wood Enamel Painted Frame & Glazed Shutter with Mild Steel Grills, And Powder coated Fittings.

Loft and Shelves

Closed One loft in the in Each bedroom & Kitchen will be provided

Kitchen

Kitchen Table-Granite Top, S.S.Sink and 2' Dadoing with Tiles.

Sanitary & Fit ups

Jaguar Fit ups and Hindware White Western Closet & Wash Basin will be provided in each toilet.

Painting

Interior walls White Cement Patti Finished with Emulsion Paint and Exterior walls Finished with Ace Paint.

Electrical

3 Phase Electrical connection, Inverter wiring, Three Phase Electrical Circuit, Concealed Wiring, Modular switches and Main Board.

Other Amenities

- a. Common Solar Geyser
- b. Video Door Security System,
- c. Solar Inverter for the Common Area lighting.
- d. 5 Passenger Lift will be provided

Sump & over hand tank

Adequate capacity size to the Total number of Flats with Metro Water Connection will be provided.

Parking Facilities

Closed Car parking & Two wheeler parking for all.

LOCATION MAP

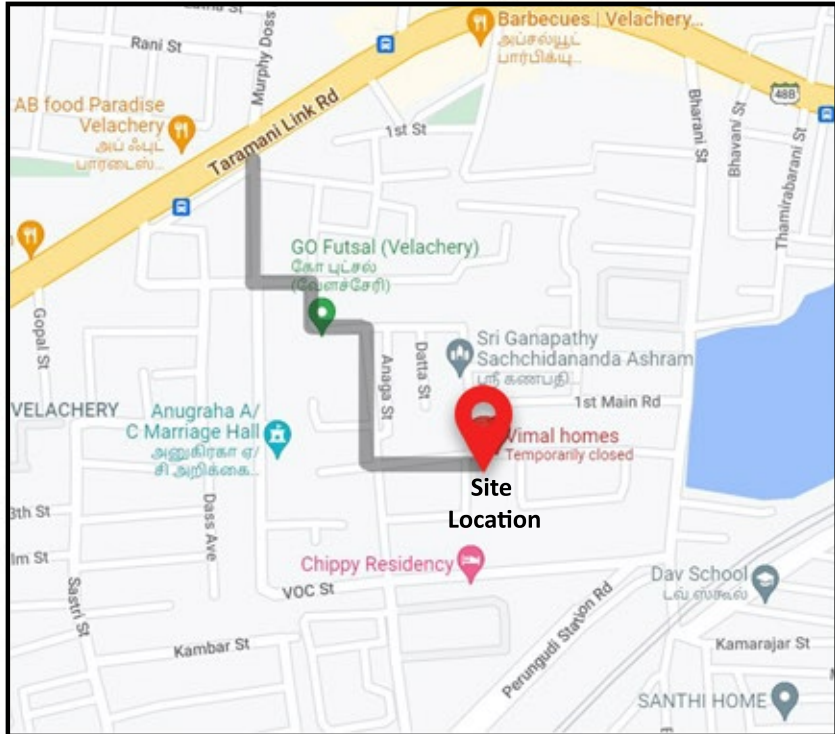

SITE ADDRESS:

**20, Park Ave 1st St, Udayam Nagar,
Velachery, Chennai- 600042**



**Scan QR Code for
exact Site Location**